

## FILTER CHOKE / SRC TYPE

### FEATURES

- ◆ Low distortion.
- ◆ The magnetic shield in a metal case is available.



### APPLICATIONS

- ◆ Magnetically shielded construction.
- ◆ Ideally Used in Printers, LCD TV, DVD, Printer, Copy Machine, Main board of the compounding machines, etc as Power Supplies's Inductors or DC-DC Converter inductors.

### ORDERING CODE

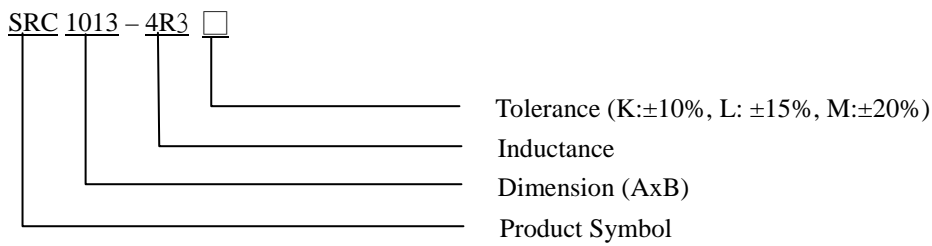

### SHAPES

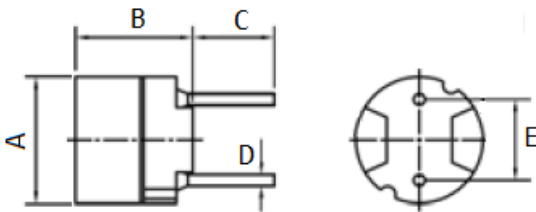

Fig. 1

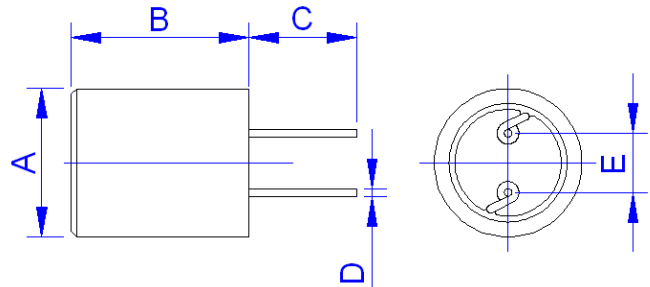

Fig. 2

### DIMENSIONS UNIT: mm (inch)

Part No.	Fig.	A (MAX)	B (MAX)	C (REF)	D (REF)	E (REF)
SRC0606	1	6.50	6.50	5.0	0.55	4.0
SRC0807	1	8.30	7.50	5.0	0.65	5.0
SRC1013	2	11.0	13.5	5.0	0.7 ± 0.1	5.0
SRC1317	2	13.5	17.5	4.5	0.7 ± 0.1	5.0
SRC1616	2	16.0	16.5	5.0	0.8 ± 0.1	7.5
SRC1619	2	16.0	19.2	5.0	1.0 ± 0.1	7.5

**CORE MASTER ENTERPRISE CO., LTD.**



<http://www.coremaster.com.tw>

## FILTER CHOKE / SRC TYPE

### ELECTRICAL CHARACTERISTICS FOR SRC0606

Part No.	Inductance (uH)	DC Resistance (Ω) Max	Rated Current (A) Max
SRC0606-220L	22 ± 15%	0.13	0.96
SRC0606-270L	27 ± 15%	0.18	0.87
SRC0606-330L	33 ± 15%	0.21	0.78
SRC0606-390L	39 ± 15%	0.26	0.72
SRC0606-470L	47 ± 15%	0.29	0.66
SRC0606-560K	56 ± 10%	0.33	0.60
SRC0606-680K	68 ± 10%	0.36	0.55
SRC0606-820K	82 ± 10%	0.39	0.50
SRC0606-101K	100 ± 10%	0.54	0.45
SRC0606-121K	120 ± 10%	0.62	0.41
SRC0606-151K	150 ± 10%	0.72	0.37
SRC0606-181K	180 ± 10%	0.88	0.34
SRC0606-221K	220 ± 10%	0.99	0.30
SRC0606-271K	270 ± 10%	1.52	0.27
SRC0606-331K	330 ± 10%	1.69	0.25
SRC0606-391K	390 ± 10%	1.85	0.23
SRC0606-471K	470 ± 10%	2.85	0.21
SRC0606-561K	560 ± 10%	3.21	0.19
SRC0606-681K	680 ± 10%	3.60	0.17
SRC0606-821K	820 ± 10%	4.87	0.16
SRC0606-102K	1000 ± 10%	5.65	0.14

### ELECTRICAL CHARACTERISTICS FOR SRC0807

Part No.	Inductance (uH)	DC Resistance (Ω) Max	Rated Current (A) Max
SRC0807-220L	22 ± 15%	0.08	1.600
SRC0807-270L	27 ± 15%	0.10	1.400
SRC0807-330L	33 ± 15%	0.14	1.300
SRC0807-390L	39 ± 15%	0.15	1.200
SRC0807-470L	47 ± 15%	0.17	1.100
SRC0807-560K	56 ± 10%	0.19	0.990
SRC0807-680K	68 ± 10%	0.21	0.890
SRC0807-820K	82 ± 10%	0.27	0.810
SRC0807-101K	100 ± 10%	0.32	0.740
SRC0807-121K	120 ± 10%	0.36	0.670
SRC0807-151K	150 ± 10%	0.51	0.600
SRC0807-181K	180 ± 10%	0.57	0.550
SRC0807-221K	220 ± 10%	0.76	0.500

CORE MASTER ENTERPRISE CO., LTD.



<http://www.coremaster.com.tw>

## FILTER CHOKE / SRC TYPE

### ELECTRICAL CHARACTERISTICS FOR SRC0807

Part No.	Inductance (uH)	DC Resistance ( $\Omega$ ) Max	Rated Current (A) Max
SRC0807-271K	270 $\pm$ 10%	0.86	0.450
SRC0807-331K	330 $\pm$ 10%	0.97	0.410
SRC0807-391K	390 $\pm$ 10%	1.28	0.370
SRC0807-471K	470 $\pm$ 10%	1.44	0.340
SRC0807-561K	560 $\pm$ 10%	1.61	0.310
SRC0807-681K	680 $\pm$ 10%	2.07	0.280
SRC0807-821K	820 $\pm$ 10%	2.33	0.260
SRC0807-102K	1000 $\pm$ 10%	2.72	0.230
SRC0807-122K	1200 $\pm$ 10%	3.98	0.210
SRC0807-152K	1500 $\pm$ 10%	4.50	0.190
SRC0807-182K	1800 $\pm$ 10%	6.81	0.170
SRC0807-222K	2200 $\pm$ 10%	7.56	0.160
SRC0807-272K	2700 $\pm$ 10%	8.54	0.140
SRC0807-332K	3300 $\pm$ 10%	9.74	0.130
SRC0807-392K	3900 $\pm$ 10%	12.9	0.120
SRC0807-472K	4700 $\pm$ 10%	14.7	0.110
SRC0807-562K	5600 $\pm$ 10%	20.4	0.099
SRC0807-682K	6800 $\pm$ 10%	23.0	0.089
SRC0807-822K	8200 $\pm$ 10%	30.6	0.081
SRC0807-103K	10000 $\pm$ 10%	35.0	0.074

### ELECTRICAL CHARACTERISTICS FOR SRC1013

Part No.	Inductance (uH)	DC Resistance ( $\Omega$ ) Max	Rated Current (A) Max
SRC1013-4R3M	4.3 $\pm$ 20%	0.021	4.60
SRC1013-6R8M	6.8 $\pm$ 20%	0.024	3.60
SRC1013-100M	10 $\pm$ 20%	0.030	3.46
SRC1013-150M	15 $\pm$ 20%	0.038	2.57
SRC1013-220M	22 $\pm$ 20%	0.045	2.21
SRC1013-330M	33 $\pm$ 20%	0.057	1.83
SRC1013-470M	47 $\pm$ 20%	0.090	1.60
SRC1013-680M	68 $\pm$ 20%	0.150	1.36
SRC1013-101M	100 $\pm$ 20%	0.210	1.10
SRC1013-151M	150 $\pm$ 20%	0.242	0.86
SRC1013-221M	220 $\pm$ 20%	0.360	0.74
SRC1013-331M	330 $\pm$ 20%	0.430	0.57
SRC1013-471M	470 $\pm$ 20%	0.810	0.48
SRC1013-681M	680 $\pm$ 20%	0.952	0.38
SRC1013-102M	1000 $\pm$ 20%	1.600	0.39

CORE MASTER ENTERPRISE CO., LTD.



<http://www.coremaster.com.tw>

## FILTER CHOKE / SRC TYPE

### ELECTRICAL CHARACTERISTICS FOR SRC1317

Part No.	Inductance (uH)	DC Resistance (Ω) Max	Rated Current (A) Max
SRC1317-330M	33 ± 20%	0.058	4.80
SRC1317-470M	47 ± 20%	0.069	4.30
SRC1317-680M	68 ± 20%	0.101	3.30
SRC1317-820M	82 ± 20%	0.110	3.10
SRC1317-101M	100 ± 20%	0.125	2.80
SRC1317-151L	150 ± 15%	0.195	2.40
SRC1317-221L	220 ± 15%	0.278	1.90
SRC1317-331L	330 ± 15%	0.360	1.60
SRC1317-471L	470 ± 15%	0.530	1.35
SRC1317-681L	680 ± 15%	0.780	1.12
SRC1317-821L	820 ± 15%	0.950	1.02
SRC1317-102L	1000 ± 15%	1.180	0.90
SRC1317-152L	1500 ± 15%	1.400	0.72
SRC1317-222L	2200 ± 15%	2.280	0.62
SRC1317-332L	3300 ± 15%	3.310	0.51
SRC1317-472L	4700 ± 15%	5.020	0.43

### ELECTRICAL CHARACTERISTICS FOR SRC1616

Part No.	Inductance (uH)	DC Resistance (Ω) Max	Rated Current (A) Max
SRC1616-4R7M	4.7 ± 20%	0.0670	12.6
SRC1616-6R8M	6.8 ± 20%	0.0935	9.8
SRC1616-100M	10 ± 20%	0.0105	9.3
SRC1616-150M	15 ± 20%	0.0145	7.1
SRC1616-220M	22 ± 20%	0.0170	6.2
SRC1616-330M	33 ± 20%	0.0270	5.0
SRC1616-470M	47 ± 20%	0.0370	4.2
SRC1616-680M	68 ± 20%	0.0560	3.3
SRC1616-820M	82 ± 20%	0.0645	2.9
SRC1616-101K	100 ± 10%	0.0680	2.7
SRC1616-151K	150 ± 10%	0.0910	2.3
SRC1616-221K	220 ± 10%	0.1550	1.8
SRC1616-331K	330 ± 10%	0.2400	1.5
SRC1616-471K	470 ± 10%	0.2800	1.2
SRC1616-681K	680 ± 10%	0.5150	1.0
SRC1616-821K	820 ± 10%	0.5750	0.96
SRC1616-102K	1000 ± 10%	0.6650	0.85

CORE MASTER ENTERPRISE CO., LTD.



<http://www.coremaster.com.tw>

## FILTER CHOKE / SRC TYPE

### ELECTRICAL CHARACTERISTICS FOR SRC1619

Part No.	Inductance (uH)	DC Resistance (Ω) Max	Rated Current (A) Max
SRC1619-100M	10 ± 20%	0.020	7.0
SRC1619-150M	15 ± 20%	0.022	6.0
SRC1619-180M	18 ± 20%	0.025	5.2
SRC1619-220K	22 ± 10%	0.028	4.9
SRC1619-330K	33 ± 10%	0.033	3.9
SRC1619-470K	47 ± 10%	0.038	3.4
SRC1619-680K	68 ± 10%	0.046	2.90
SRC1619-101K	100 ± 10%	0.053	2.50
SRC1619-151K	150 ± 10%	0.077	2.00
SRC1619-221K	220 ± 10%	0.140	1.60
SRC1619-331K	330 ± 10%	0.270	1.30
SRC1619-471K	470 ± 10%	0.460	1.10
SRC1619-681K	680 ± 10%	0.560	0.90
SRC1619-102K	1000 ± 10%	0.690	0.75

**Notes:**

- 1) Open Circuit Inductance Test Parameters: 1.0kHz, 0.25Vrms, 0.0Aac, Test Equipment : HP4284A or WK3260B LCR Meter.
- 2) DCR limits @ 20°C. Test Equipment: CH502BC.



**CORE MASTER ENTERPRISE CO., LTD.**

<http://www.coremaster.com.tw>